



5 Andover Court, Hannibal Road, Staines-Upon-Thames, TW19 7HQ

This well presented two bedroom split level maisonette benefits from superb views. Accommodation comprises of lounge/diner and two double bedrooms. Other notable features include re-fitted kitchen, gas central heating, bathroom, separate WC and double glazing. The property also benefits from being within walking distance to local amenities and has superb access to Heathrow airport.



Floor Plan

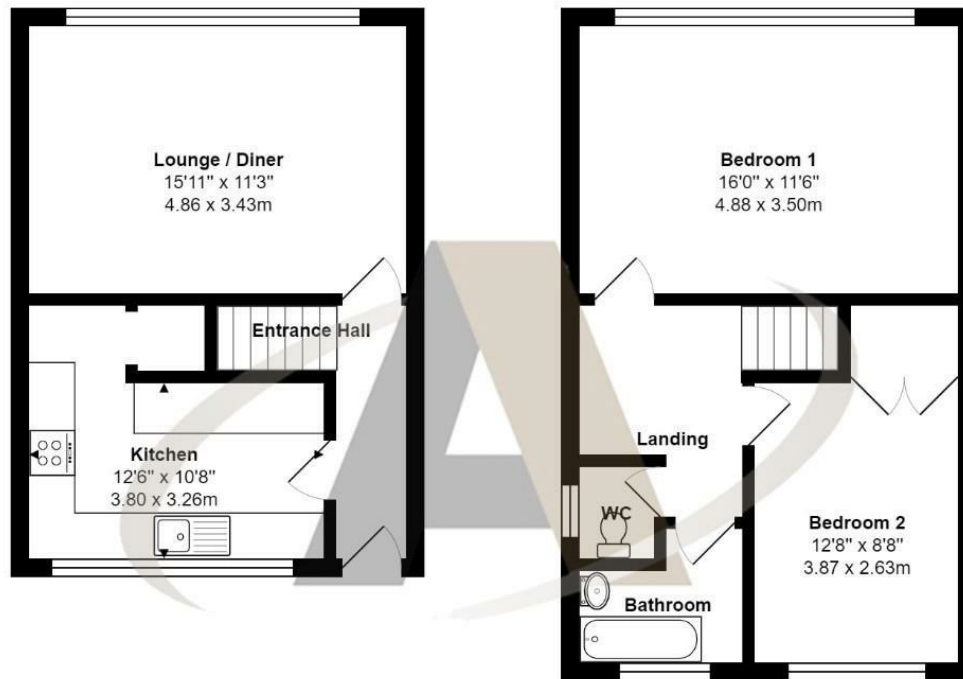

Andover Court, Stanwell

Total Area: 790 ft² ... 73.4 m²

All measurements are approximate and for display purposes only



Features

- Two Double Bedrooms
- Lounge/Diner
- Bathroom
- Double Glazing
- Split Level Maisonette
- Re-Fitted Kitchen
- Seperate WC
- Gas Central Heating

